

SHL 手動式油壓千斤頂附爪型

- 碳鋼底座，自動化焊接，品質穩定。
- 主軸採用合金鋼硬鉻處理，耐久不生銹。
- 適用於重機械校正水平用，及一般千斤頂無法使用的狹小場所。

Manual Hydraulic Bottle Jack with Toe-Lift

- ※ Carbon steel base with automatic welding makes stable quality.
- ※ Chrome plated plunger resists corrosion and extends life.
- ※ For heavy equipment lifting or check level with minimum available access.



Model Number	Top Cap.	Toe-Lift Cap.	Stroke	Coll Height	Ext. Height	Plunger Dia.	Base Dimensions	Height	Toe-Lift Base	Weight
型號	頂部荷重 U (ton)	爪部荷重 F (ton)	揚程 (mm)	本身高 A (mm)	伸長總高 B (mm)	主軸直徑 J (mm)	底座尺寸 L x W (mm)	爪高 K (mm)	爪塊尺寸 L1 x W1 (mm)	總重 (kg)
SHL-05S	5	2.5	110	230	340	32	152 X 200.5	16	78 X 47	8.5
SHL-10S	10	5	135	277	412	42	185 X 235	22	98 X 55	20.0
SHL-10B	10	5	75	211	286	42	220 X 238	22	130 X 52	18.15
SHL-20S	20	10	150	317	467	55	220 X 240	25	132 X 48	31.5
SHL-20B	20	10	73	239	312	55	220 X 242	25	132 X 46	24.9
SHL-30S	30	15	150	335	486	62	265 X 272	28	149 X 60	44.0
SHL-50S	50	25	150	370	520	85	340 X 354	40	190 X 75	88.5
SHL-10P	10	5	134	266	400	42	125 X 275	50	100 X 100	20.0
SHL-10PH	10	5	134	266	400	42	125 X 275	50	100 X 100	20.0

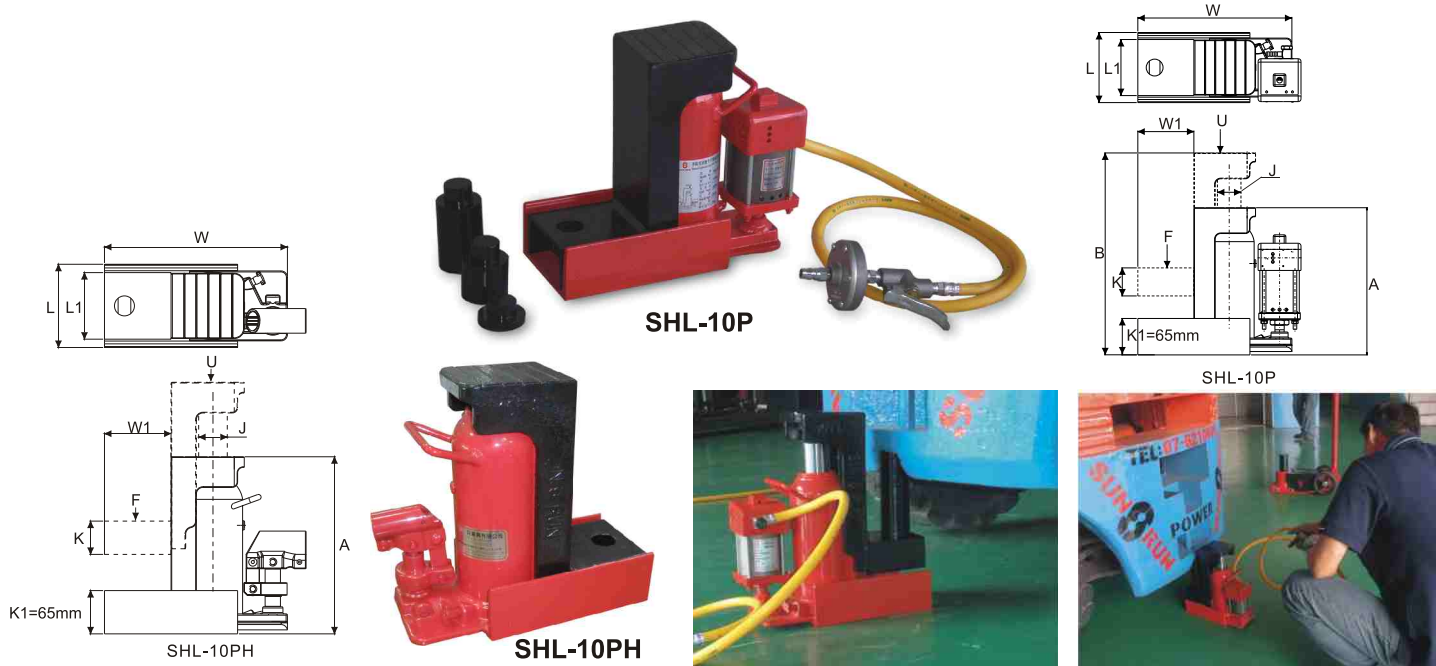

SLJM-10 油壓起道機

- 可獨立操作，高機動性。
- 低爪位。
- 最少施力，方便操作。
- 重量輕。

Lifting Jacks

- ※ Self-contained models for maximum versatility.
- ※ Low toe heights fit in tight clearances.
- ※ The lowest handle effort for easy operation.
- ※ The lowest weights for reduced back injuries.

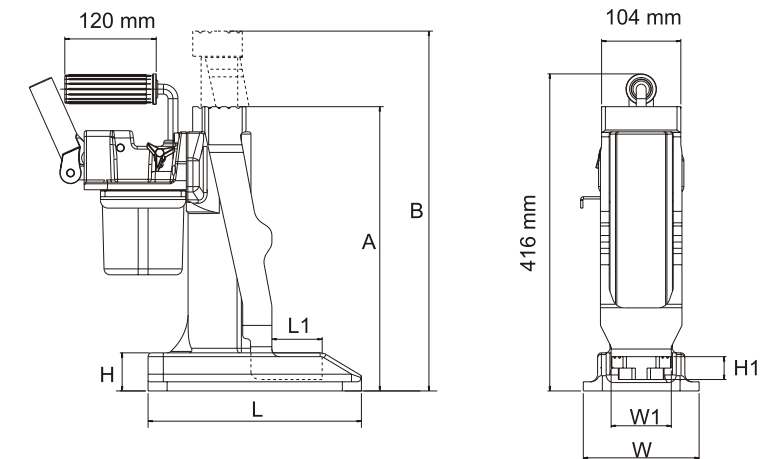

DERVE011-A04 強力爪塊 Strong Toe-Lift
優點：一體成型鑄造，耐荷重，不易變形、斷裂。
Advantage: Casting integral, heavy duty, not easily deformed and fracture.

Model No.	Top cap.	Low toe-Lift cap.	Stroke	Min. Height	Ext. Height	Base Dimensions	Top Toe-Lift Dimensions	Weight	Air pressure Rang
型號	頂部荷重 (ton)	爪部荷重 (ton)	揚程 (mm)	本身高 A (mm)	伸長總高 B (mm)	底座尺寸 L x W x H (mm)	頂爪尺寸 L1 x W1 x H1 (mm)	總重 (kg)	使用壓力 (bar)
SLJM-10	10.0	8.5	225	373	598	280 x 152 x 50	66 x 79 x 30	19.5	560